

XPO – XFIT100SKM / XFIT100SKM_CP / XFIT100SKM_MB

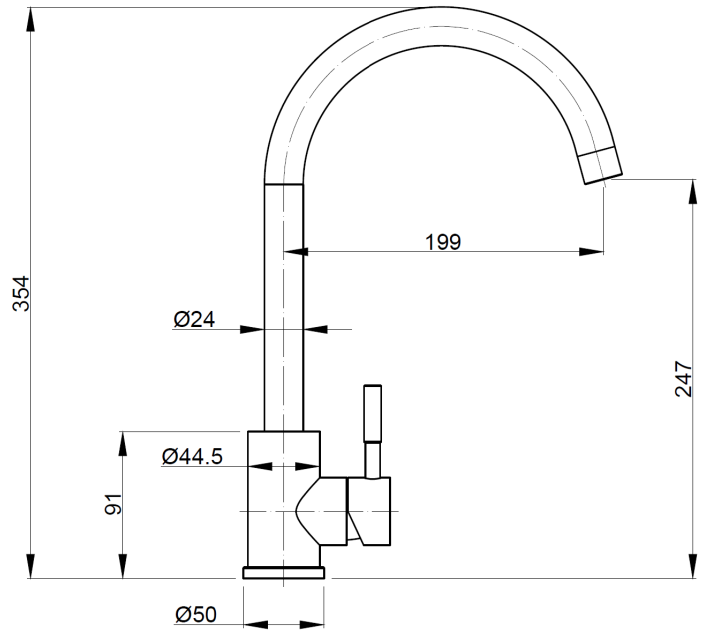

Note: Drawings are not to scale and are for reference only. Specifications and sizes can be changed by the manufacturer without notice. Refer to physical unit prior to installation.

Product Specifications

Base Material	Stainless Steel
Finish	Satin / Chrome Plated / Matt Black
Installation	Xpressfit Top Mount
Height	354mm
Projection	199mm
WELS Rating	4 star water efficiency, 7.5L per minute
Cartridge Size	35mm
Warranty	2 years parts and labour, 15 years replacement on cartridge and PEX inlet hoses